



Brokerage with vision. Real estate with results.

MILL END CENTER

US Highway 17 South, Mill End Court, Elizabeth City, NC

Commercial Lots For Sale ZONED HIGHWAY BUSINESS

Suitable for:
**Retail, Office, Business,
Professional & Personal Service,
Recreational, Educational, & Institutional uses.**

Lot 2
1.08 ac. +-
\$150,000

Lot 3
1 ac. +-
\$175,000

Lot 4
1.03 ac. +-
\$150,000

Lot 5
2.32 ac. +-
\$400,000

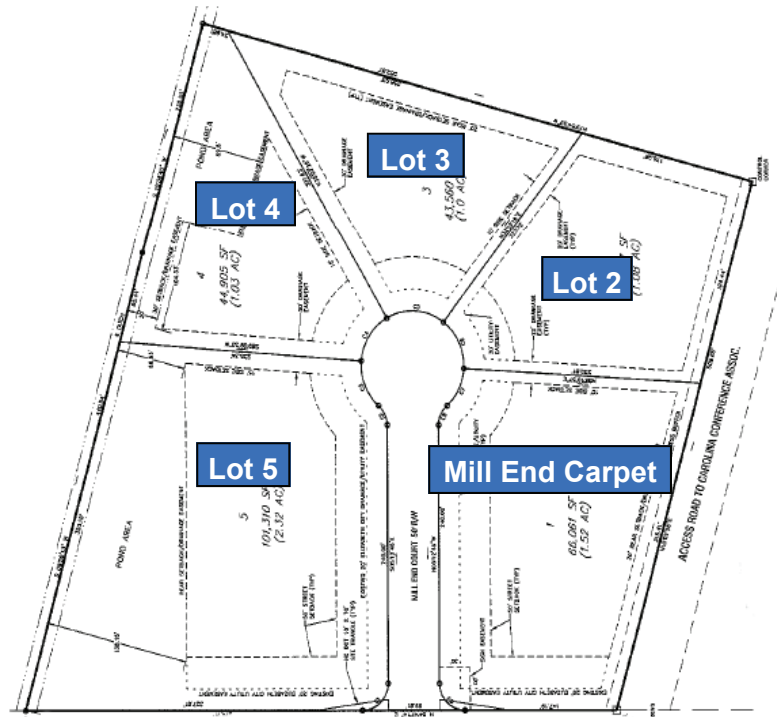

The Economic Hub of the 6 County Albemarle Trade Area



2007 DEMOGRAPHICS:

	Population	Average HH Income
1 mile	2,852	\$41,749
3 mile	20,631	\$42,611
5 mile	30,147	\$46,519
10 mile	44,584	\$40,307
20 mile	79,957	\$41,758

Elizabeth City – 19,449
Pasquotank County – 39,968
6 Surrounding Counties: 112,787
Pasquotank, Camden, Currituck,
Perquimans, Chowan & Gates



Elizabeth City is located in Pasquotank County, which is situated in northeast North Carolina just outside of the Norfolk-Newport News, Virginia, MSA. The population of Pasquotank County grew 12% from 2000 to 2006 and is a prime market for many national retailers yet to locate to an area that serves over 100,000 people.

Shawna Robertson, Broker
(252) 435-7550
SRobertson@Katsias.com



The Katsias Company
512 S. Lynnhaven Rd, Suite 101
Virginia Beach, VA 23452
T: (757) 490 3585 | F: (757) 490-3676
www.Katsias.com

